**THORNTON**Thornton  
Eletrônica Ltda**NEI-19/16/5****Effective Core Parameters:**

<b>S I/A</b>	1,5	mm <sup>-1</sup>
<b>Le</b>	40,0	mm
<b>Ae</b>	26,0	mm <sup>2</sup>
<b>Amin</b>	- - -	mm <sup>2</sup>
<b>Ve</b>	1040,0	mm <sup>3</sup>

Weight Approx. (piece) 5,0 g

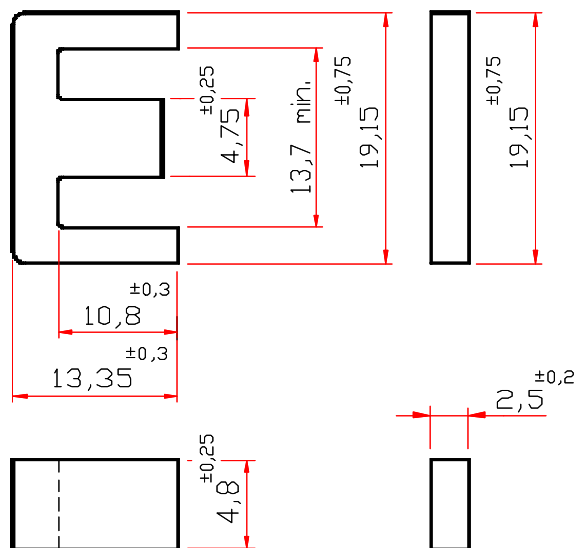

Dimensions in mm

**WITH GAP**

Items with gap by consulting

**WITHOUT GAP**

DESCRIPTION ORDER	MATERIAL	Al [nH]	Tol.%	~g [mm]	~ µe
NEI-19/16/5-1100-IP6	IP6	1100	+30 / -20	- - -	1348
NEI-19/16/5-1700-TH50	TH50	1700	+30 / -20	- - -	2083

Others AL's by consulting